

**Novatech**<sup>®</sup>





## **NovaTHERM** — To keep you warm all winter

The NovaTHERM product line is specifically designed to limit heat loss. Some of these insulated glass units are compliant with the Energy Star zone 1, 2 and 3 requirements, and provide very high energy efficiency. Thanks to NovaTHERM, you can enjoy the highest levels of interior comfort, even during the coldest days.

**NovaTHERM, a sensible choice for your well-being, heating savings and the environment!**

# NovaTHERM

| NovaTHERM products offer a unique experience depending on the glass and spacer selection:        | GLASS THICKNESS | VISIBLE LIGHT TRANSMITTANCE LT (%) | SOLAR HEAT GAIN COEFFICIENT SHGC | SHADING COEFFICIENT SC | LIGHT REFLECTION |                  | R VALUE (H.FT <sup>2</sup> .F)/BTU WINTER | U VALUE BTU/(H.FT <sup>2</sup> .F) WINTER |
|--|-----------------|------------------------------------|----------------------------------|------------------------|------------------|------------------|---|---|
|  |                 |                                    |                                  |                        | EXTERIOR LRe (%) | INTERIOR LRi (%) |   |   |
|  NovaTHERM Clear | 3mm             | 82                                 | 0.79                             | 0.91                   | 15               | 15               | 2.18                                      | 0.46                                      |
|  NovaTHERM 80/70 | 3mm             | 81                                 | 0.70                             | 0.81                   | 13               | 13               | 3.59                                      | 0.28                                      |
|  NovaTHERM LUX   | 3mm             | 82                                 | 0.74                             | 0.85                   | 13               | 13               | 3.65                                      | 0.27                                      |
|  NovaTHERM 70/36 | 3mm             | 70                                 | 0.38                             | 0.44                   | 11               | 13               | 3.99                                      | 0.25                                      |

Finished 7/8" insulated glass unit: 90% argon. Reference standard: NFRC 2010. 3 to 6mm thickness available.

## Options

### Spacers

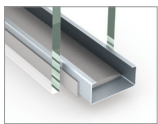

#### Intercept

- Best price to quality ratio

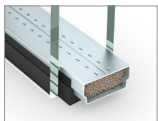

#### Aluminum

- Traditional spacer
- Shapes and curves available

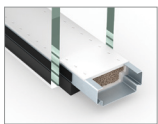

#### Non-Conducting Spacers

- Superior performance
- Shapes, curves and colors available

### Glass

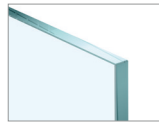

#### Standard Glass

**Tempered Glass** — Two to five times more resistant than ordinary glass. When it breaks, it shatters into very small, dull-edged pieces that reduce the risk of injury.

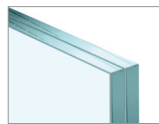

**Laminated Glass** — Two glass panes assembled with a plastic film. When it breaks, the glass stays in place. Suited to slow down break-ins, limit noise and reduce the effect of UV rays.

### Sealant

Because of atmospheric conditions, every window is subject to panel deformation. We recommend using the right sealant for your application:

**Polysulfide** — Adapted to all type of glass. Installation in a 4-sided frame.

**Hot-melt** — Adapted for small to medium openings, clear and Low E residential glass. Installation in a 4-sided frame.



### Patio Doors

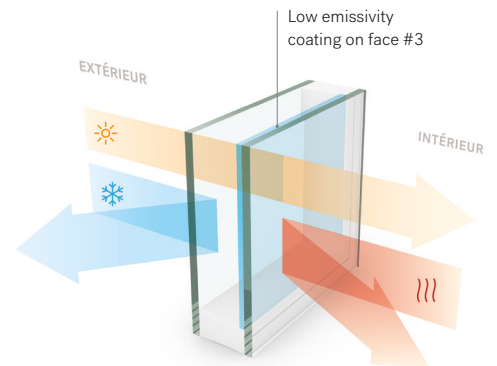

**Loft and Urbania aluminum patio doors** — The NovaTHERM product line can also be integrated into our aluminum patio doors to ensure color consistency and energy efficiency for your project.



NovaTHERM 80/70,  
NovaTHERM LUX  
& NovaTHERM 70/36

-  Captures the heat from solar rays
-  Repels the cold
-  Keeps the heat

**Novatech®**

novatechgroup.com

Making insulated glass units since 1982

Telephone: 514-289-8204  
Toll Free: 1-844-826-2154  
service.anjou@novatechgroup.com



Novatech offers a 10 year warranty on all insulated glass components